

SAN DIEGO



*HOTEL DEL CORONADO*™

CALIFORNIA



## { ACCOMMODATIONS }

Enjoy a variety of options including the newly renovated and elegant guestrooms in the Victorian Building, contemporary luxury in the Ocean Towers and Cabanas, and the ultra-luxe cottages and villas at Beach Village.



## { DINING }

A variety of spectacular restaurants overlook the Pacific. Enjoy Southland coastal cuisine at the award-winning 1500 OCEAN, the day's freshest catch at Sheerwater and fireside cocktails and ocean views at the Sun Deck.



## { ACTIVITIES }

Named one of the Top 10 Beaches in America, Coronado offers endless recreation options.

## { SPA & FITNESS }

Named one of the Top 20 Hotel Spas in the World by *Travel + Leisure*.



HOTEL DEL CORONADO®

1500 ORANGE AVENUE, CORONADO, CA 92118 | TEL: (619) 435-6611 (800) HOTEL-DEL FAX: (619) 522-8239 | WWW.HOTELDEL.COM/MEETINGS

THE KSL RESORTS COLLECTION ■ KSLRESORTS.COM

HOTEL DEL CORONADO® ■ BEACH VILLAGE AT THE DEL® ■ LA COSTA RESORT AND SPA® ■ RANCHO LAS PALMAS RESORT & SPA®  
BARTON CREEK RESORT & SPA® ■ MONTEUCIA RESORT & SPA™ ■ THE HOMESTEAD® ■ VAIL MOUNTAIN LODGE & SPA™

1.866.KSL.7727

## { ELEVATED GROUP DINING }

The Del's innovative culinary team takes traditional banquet dining to a whole new level.



## { GROUP ACTIVITIES }

Our full-time recreation staff will plan and execute unforgettable team-building activities.



## { TECHNOLOGY }

Our professional on-site audio-visual company will attend your every need.

## { WEB SITE }

An interactive meetings web site gives planners access to maps, photography, menus and more.



The Del is the oldest hotel in the U.S. to receive Green Seal certification.

# { MEETINGS THAT INSPIRE }

The location and experience of a meeting is just as important as its agenda.  
Creativity doesn't come from a box; it is inspired by unique surroundings.



# MEETINGS & EVENTS MAP

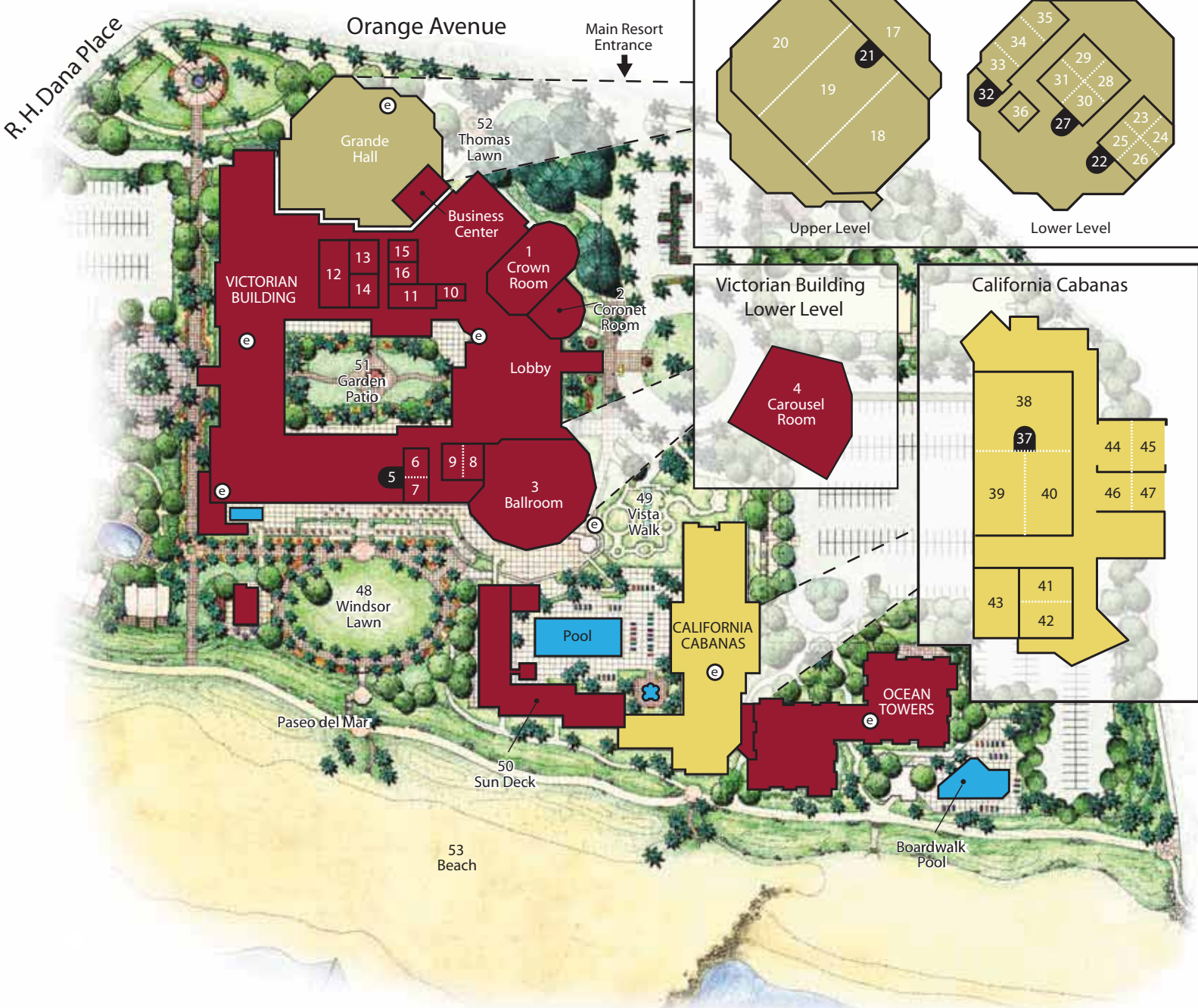

## { UNIQUE EVENT SPACE }

This National Historic Landmark blends an enchanting Victorian setting with 65,000 square feet of indoor and outdoor oceanfront meeting space.

# INDOOR & OUTDOOR MEETING FACILITIES

Map No	Conference Room	Square Footage	Dimensions	Celling	Classroom	Theater	Conference	U-shape	Hollow Square	Banquet 6'Rounds	Banquet 5'Rounds	Banquet 5'Rounds
										of 10	of 10	of 10
<b>INDOOR VENUES</b>												
1	Crown Room	9,318	51 x 155	30'	512	1088	128	180	104	660	620	496
2	Coronet Room	3,575	57 x 65	25'6"	92	182	48	44	56	120	180	184
3	Ballroom	12,567	126 x 100	30'1"	528	1110	84	68	72	720	720	576
4	Carousel Room	4,965	79 x 79	9'5"	128	288	48	36	48	330	400	320
5	Windsor Complex	1,591	26 x 53	8'1"	80	168	44	48	52	80	100	80
6	Windsor Room	583	20 x 26	8'1"	32	60	20	20	16	30	40	32
7	Embassy Room	1,008	26 x 33	8'1"	40	80	28	24	28	50	60	48
8	Crystal Room	768	24 x 32	9'3"	40	72	24	24	30	60	50	48
9	Continental Room	1,183	32 x 37	9'3"	72	120	28	32	40	100	70	72
	Crystal/Continental Room	1,951	32 x 61	9'3"	124	216	52	52	56	120	120	104
10	Executive Room	390	15 x 31	10'	—	—	18	—	—	—	—	—
11	Garden Room	1,645	33 x 50	8'6"	96	169	38	32	40	110	110	88
12	Hanover Room	1,415	29 x 53	8'4"	64	100	32	20	24	100	80	64
13	Stuart Room	973	28 x 34	9'1"	64	80	28	20	24	60	60	48
14	Tudor Room	508	15 x 31	7'8"	24	50	28	—	—	30	30	24
15	Kent Room	350	17 x 23	8'4"	16	30	20	12	—	20	20	16
16	York Room	346	16 x 23	8'4"	16	30	20	12	—	20	20	16
	York/Kent Room	696	17 x 46	8'4"	32	63	24	22	—	40	50	40
17	Grande Hall Foyer	10,943	87 x 133	22'2"	784	1288	114	124	144	730	920	726
18	Empress Hall	3,488	44 x 89	22'2"	184	342	72	88	96	208	260	208
19	Regent Hall	3,968	44 x 90	22'2"	272	522	80	76	90	210	280	224
20	Viceroy Hall	3,487	44 x 88	22'2"	184	342	72	88	90	190	260	208
	Empress/Regent Hall	7,456	44 x 179	22'2"	528	1056	72	92	112	460	620	496
	Regent/Viceroy Hall	7,455	44 x 178	22'2"	516	1056	84	92	112	460	620	496
21	Upper Grande Hall	10,943	87 x 133	22'2"	784	1288	114	124	162	730	920	640
22	Spreckels Complex	1,515	35 x 41	7'5"	80	160	36	28	32	60	90	72
23	Spreckels Salon A	325	15 x 22	7'5"	16	33	16	12	—	20	20	16
24	Spreckels Salon B	502	20 x 22	7'5"	20	40	20	12	—	20	20	24
25	Spreckels Salon C	293	15 x 20	7'5"	16	32	16	12	—	20	20	16
26	Spreckels Salon D	394	20 x 20	7'5"	16	40	16	12	—	20	20	24
	Spreckels A/B	830	20 x 44	7'5"	44	66	28	20	—	50	50	40
	Spreckels C/D	687	20 x 40	7'5"	36	60	28	20	—	50	50	48
27	Wilder Complex	1,602	40 x 42	7'4"	96	176	32	28	40	120	80	64
28	Wilder Salon E	424	20 x 22	7'4"	24	32	20	12	—	20	20	24
29	Wilder Salon F	425	20 x 22	7'4"	24	30	20	12	—	20	30	24
30	Wilder Salon G	376	20 x 22	7'4"	24	35	20	12	—	20	30	24
31	Wilder Salon H	377	20 x 23	7'4"	24	35	20	12	—	20	30	24
	Wilder E/F	849	20 x 44	7'4"	48	70	28	28	—	50	50	40
	Wilder F/H	753	20 x 45	7'4"	48	48	28	28	—	30	40	32
32	Edison Complex	1,619	27 x 63	7'8"	80	150	52	44	48	110	90	72
33	Edison I	506	27 x 19	7'8"	32	59	20	20	—	20	30	24
34	Edison J	621	27 x 24	7'8"	40	56	20	20	—	40	40	32
35	Edison K	492	27 x 20	7'8"	32	59	20	20	—	20	30	24
	Edison I/J	1,127	27 x 43	7'8"	64	119	36	32	—	50	50	48
	Edison J/K	1,113	27 x 43	7'8"	72	126	36	28	—	50	60	64
36	Board Room	263	15 x 18	7'11"	—	—	10	—	—	—	—	—
37	Tropics	3,974	44 x 88	11'4"	256	490	114	80	96	320	320	256
38	Seabreeze Room	2,167	44 x 48	11'4"	144	240	36	44	128	160	160	128
39	Palm Room	923	22 x 40	11'4"	52	100	32	28	32	60	60	48
40	Sunset Room	884	22 x 40	11'4"	52	88	32	28	32	60	60	48
	Palm/Sunset Room	1,807	44 x 40	11'4"	96	198	36	36	40	120	12	96
41	Strand Room	419	22 x 20	9'11"	24	40	16	12	—	20	30	24
42	Bayside Room	453	22 x 20	9'11"	24	40	16	12	16	20	30	24
	Bayside/Strand Room	873	22 x 40	9'11"	48	110	28	28	32	60	50	48
43	Pointe Room	850	22 x 93	9'10"	64	100	28	28	32	60	50	40
44	Pacifica Room	363	20 x 19	9'7"	16	28	20	12	16	20	20	16
45	Tide Room	370	19 x 19	9'7"	16	40	20	12	—	20	20	16
	Pacifica/Tide Room	733	22 x 38	9'7"	48	72	32	28	24	40	40	40
46	Coastal Room	492	19 x 25	10'	24	69	20	20	—	20	30	24
47	Surf Room	478	18 x 25	10'	32	54	20	20	—	20	30	24
	Coastal/Surf room	969	37 x 25	10'	64	110	32	28	32	60	60	52
<b>OUTDOOR VENUES</b>												
48	Windsor Lawn	16,956	180 x 120	—	—	—	—	—	—	1,220	—	—
49	Vista Walk	12,032	—	—	—	—	—	—	—	80	—	—
50	Sun Deck	13,140	—	—	—	—	—	—	—	—	—	—
	Sun Deck Back	6,011	—	—	—	—	—	—	—	—	—	—
51	Garden Patio	10,764	—	—	—	—	—	—	—	440	—	—
52	Thomas Lawn	8,000	—	—	—	—	—	—	—	—	—	—
53	Beach	—	—	—	—	—	—	—	—	1,220	—	—